

AQUILA 10W

AQUILA RECESSED MOVABLE DOWN LIGHT 2X5W

Indoor Luminaire

Product Code:

LAQL01R205XC/ LAQL01R205XN/ LAQL01R205XW
10W - 750lm - 6500K - CRI>80 Ra - Beam Angle - 22°



Technical Specifications

Operating Temperature	-10°C to 40°C
Rated Input Voltage & Frequency	220 ~ 240 VAC, 50Hz
Rated Input Wattage	10W ± 10%
Rated Input Current	0.046 Amp (Nominal)
Power Factor	≥0.90
ATHD	<15%
Rated Luminous Flux	750 lm / 720 lm / 680 lm (tolerance as per BIS)
Rated Luminaire Efficacy	75 lm/W / 72 lm/W / 68 lm/W (tolerance as per BIS)
Correlated Color Temperature (CCT)	6500 K / 4000 K / 3000 K (tolerance as per ANSI)
Color Rendering Index (CRI)	>80 Ra / >90 Ra / >90 Ra
Beam Angle	22° (within the permissible limits)
Driver Efficiency	>85%
LED Life Span	>50000 Hrs (Ta=25°C @L70)
Housing	Aluminium Housing with White Powder Coating
Lens / Reflector	PC Diffuser
Mounting	Recessed

Protections

Over Voltage Protection	Withstand upto 440V/AC for 4 Hrs.
Surge Protection	±4.0KV
Protection Class	Class II
Ingress Protection (IP Rating)	IP20
Impact Protection (IK Rating)	IK02
Short Circuit Protection	Provided
Open Circuit Protection (No Load)	Provided
Reverse Polarity Protection	Provided

All technical data is subject to industry-standard tolerances.

Light Distribution

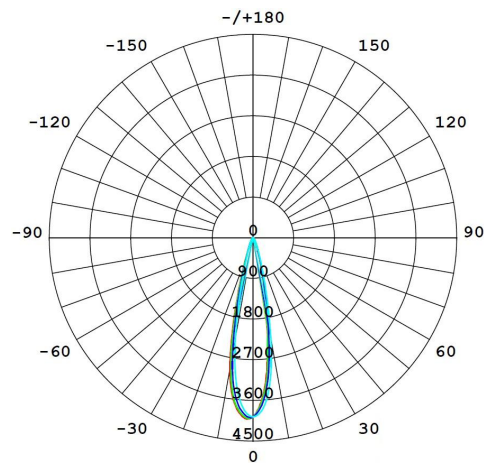

UGR Table

ceiling/cavity	0.7	0.7	0.5	0.5	0.3	0.7	0.7	0.5	0.5	0.3
walls	0.5	0.3	0.5	0.3	0.3	0.5	0.3	0.5	0.3	0.3
working plane	0.2	0.2	0.2	0.2	0.2	0.2	0.2	0.2	0.2	0.2
Room dimensions	Viewed crosswise					Viewed endwise				
x = 2H y = 2H	10.4	11.0	10.6	11.2	11.3	11.1	11.7	11.3	11.9	12.0
3H	10.2	10.8	10.4	11.0	11.2	10.9	11.5	11.2	11.7	11.9
4H	10.1	10.7	10.4	10.9	11.1	10.8	11.4	11.1	11.6	11.8
6H	10.0	10.6	10.3	10.8	11.1	10.8	11.3	11.0	11.5	11.8
8H	10.0	10.5	10.3	10.8	11.0	10.7	11.2	11.0	11.5	11.7
12H	10.0	10.5	10.3	10.7	11.0	10.7	11.2	11.0	11.4	11.7
4H 2H	10.2	10.7	10.4	10.9	11.2	10.9	11.4	11.1	11.6	11.9
3H	10.0	10.5	10.3	10.8	11.0	10.7	11.2	11.0	11.5	11.7
4H	9.9	10.4	10.2	10.6	10.9	10.6	11.1	10.9	11.3	11.6
6H	9.8	10.2	10.2	10.5	10.9	10.5	10.9	10.9	11.2	11.6
8H	9.7	10.1	10.1	10.5	10.8	10.4	10.8	10.8	11.2	11.5
12H	9.7	10.0	10.1	10.4	10.8	10.4	10.7	10.8	11.1	11.5
8H 4H	9.7	10.1	10.1	10.5	10.8	10.4	10.8	10.8	11.2	11.5
6H	9.6	9.9	10.0	10.3	10.7	10.3	10.6	10.7	11.0	11.4
8H	9.6	9.8	10.0	10.3	10.7	10.3	10.5	10.7	11.0	11.4
12H	9.5	9.7	10.0	10.2	10.6	10.2	10.4	10.7	10.9	11.3
12H 4H	9.7	10.0	10.1	10.4	10.8	10.4	10.7	10.8	11.1	11.5
6H	9.6	9.8	10.0	10.3	10.7	10.3	10.5	10.7	11.0	11.4
8H	9.5	9.7	10.0	10.2	10.6	10.2	10.4	10.7	10.9	11.3
Variations with the observer position at spacings(CIE Pub.117):										
S = 1.0H	+ 2.4 / - 9.7					+ 2.6 / - 7.7				
1.5H	+ 3.2 / - 8.0					+ 3.5 / - 7.0				
2.0H	+ 5.8 / - 1.5					+ 5.6 / - 1.5				

Product Dimensions (DiaXH)

Ø 138mm x 88mm (Tol. ± 5 mm), Cutout Size 132mm

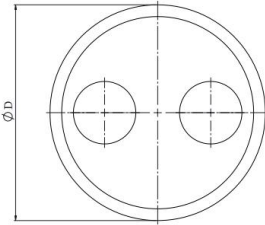
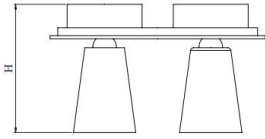

Applications

Residences, Offices, Small Retail Shops,
Hotels, Coffee Shops, Restaurants, Hospitals,
area lighting and for other indoor applications.